

GRIP TIGHT™ ADAPTER

E-Z KLEEN Ball Bearings

DODGE® GRIP TIGHT Adapter E-Z KLEEN® Ball Bearings for the Food and Beverage Industry

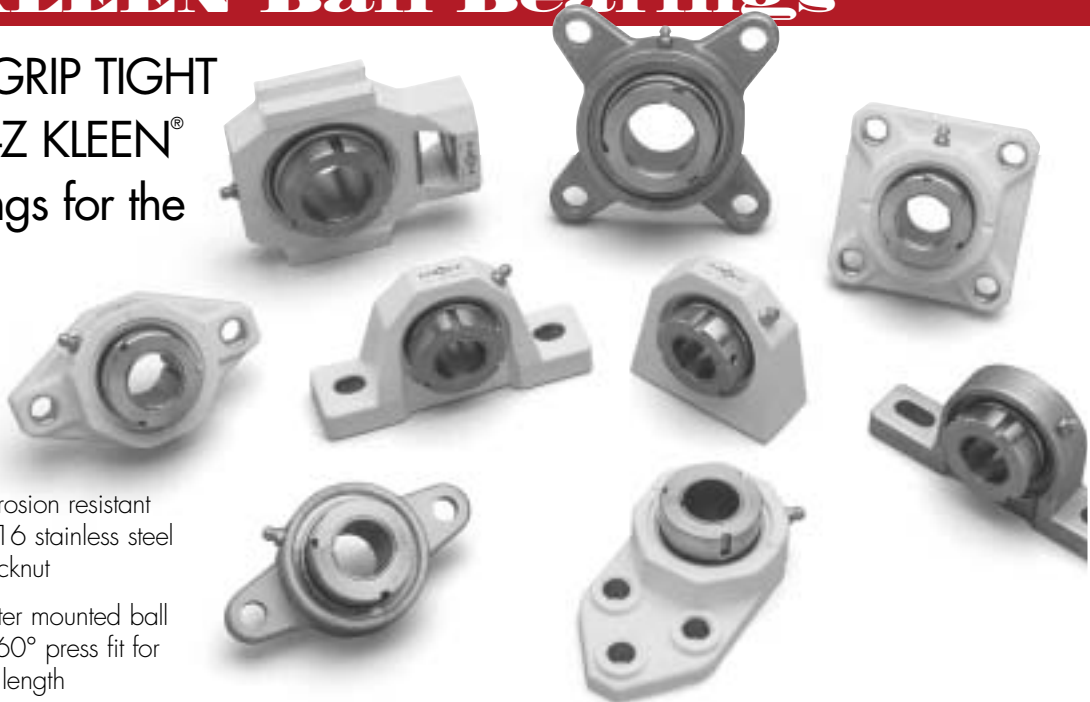

- E-Z KLEEN Corrosion resistant bearing with 316 stainless steel adapter and locknut
- Thin wall adapter mounted ball bearing with 360° press fit for the full bearing length
- PROGUARD™ PLUS positive contact, low drag, single lip seal with stainless steel flinger for maximum protection and grease retention
- Injected molded, polymer housing or investment cast 316 stainless steel housing with solid base
- Antimicrobial agent in polymer housing retards bacteria and fungus growth
- Accepts E-Z KLEEN "pop-in" style end covers
- Interchangeable mounting dimensions with other washdown housed bearing products
- Polymer – Pillow block, two and four bolt flange, 204 through 210 series (3/4 - 2; 20 mm - 50 mm); tapped base, flanged bracket, and wide slot take up, 204 through 207 series (3/4 - 1 7/16, 20mm - 35 mm).
- Stainless – Pillow block, two and four bolt flange, 204 through 208 and 210 series (3/4 - 1 1/2, 1 15/16 & 2; 20 mm - 40 mm, & 50 mm).



Typical fretting corrosion and shaft damage with setscrew bearing. Bearing quite often is "frozen" to shaft



No fretting corrosion or shaft damage with the GRIP TIGHT Adapter ball bearing. Bearing is easily removed from shaft.

- ✓ Baking
- ✓ Confectionary
- ✓ Grain
- ✓ Brewing
- ✓ Snack & Beverage
- ✓ Ready-To-Eat Meat Processing
- ✓ Primary Poultry & Red Meat Processing

GRIP TIGHT Adapter E-Z KLEEN Ball Bearings



GRIP TIGHT Adapter ball bearings are fit to the shaft with an adapter and locknut system. This patented design alleviates setscrew damage, removes fretting corrosion and eases disassembly with a built-in bearing puller. All GRIP TIGHT Adapter E-Z KLEEN locknuts and adapters are made from 316 series stainless steel. GRIP TIGHT Adapter E-Z KLEEN corrosion resistant bearings offer the greatest bearing steel corrosion resistance available, including versus bearing grade 400 series stainless steel.

DODGE E-Z KLEEN polymer housings are injection molded and contain an anti-microbial agent that retards bacteria and fungus growth. Polymer housings are of solid cross-section, yielding maximum strength and contain no cavities or filled areas that can trap contaminants. All hardware is made from 316 stainless steel for maximum corrosion resistance



DODGE E-Z KLEEN stainless steel housings are investment cast of 316 stainless steel. They contain no cavities or filled areas that can trap contaminants.



The DODGE PROGUARD PLUS seal with flinger is a combination contact land-riding seal and labyrinth. The grease barrier between the seal and flinger acts as a third seal, keeping lubrication in and contaminants out. All GRIP TIGHT Adapter E-Z KLEEN bearings include the PROGUARD PLUS seal with a 316 stainless steel flinger.

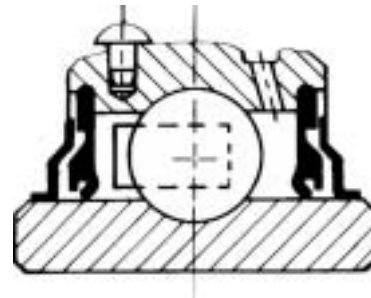

Closed and open E-Z KLEEN end closures with drain hole can be used on both stainless steel and polymer housings. For through-bore applications, the open end closure includes a shaft riding labyrinth seal with elongated fingers front and back to prevent liquid entry into the closure. Available from stock.

www.rockwellautomation.com www.dodge-pt.com www.reliance.com www.ptplace.com www.ptplace.ca www.ptplace.com.mx

Corporate Headquarters

Rockwell Automation, 777 East Wisconsin Avenue, Suite 1400, Milwaukee, WI, 53202-5302 USA, Tel: (1) 414.212.5200, Fax: (1) 414.212.5201

Headquarters for Dodge and Reliance Electric Products

Americas: Rockwell Automation, 6040 Ponders Court, Greenville, SC 29615-4617 USA, Tel: (1) 864.297.4800, Fax: (1) 864.281.2433
Europe/Middle East/Africa: Rockwell Automation, Brühlstraße 22, D-74834 Elztal-Dallau, Germany, Tel: (49) 6261 9410, Fax: (49) 6261 17741
Asia Pacific: Rockwell Automation, 55 Newton Road, #11-01/02 Revenue House, Singapore 307987, Tel: (65) 6356-9077, Fax: (65) 6356-9011



Headquarters for Allen-Bradley Products, Rockwell Software Products and Global Manufacturing Solutions

Americas: Rockwell Automation, 1201 South Second Street, Milwaukee, WI 53204-2496 USA, Tel: (1) 414.382.2000, Fax: (1) 414.382.4444
Europe/Middle East/Africa: Rockwell Automation SA/NV, Vorstlaan/Boulevard du Souverain 36, 1170 Brussels, Belgium, Tel: (32) 2 663 0600, Fax: (32) 2 663 0640
Asia Pacific: Rockwell Automation, 27/F Citicorp Centre, 18 Whitfield Road, Causeway Bay, Hong Kong, Tel: (852) 2887 4788, Fax: (852) 2508 1846

RAPS-1074-1

9/03-5M-K

This material is not intended to provide operational instructions. Appropriate Rockwell Automation instruction manuals and precautions should be studied prior to installation, operation or maintenance of equipment.

Copyright © 2003 Rockwell Automation. All rights reserved. Printed in USA.
DODGE, RELIANCE ELECTRIC, GRIP TIGHT, PROGUARD, E-Z KLEEN are trademarks of Rockwell Automation.